

ABOUT FILTERS AND SERVICE LIFE

The life spans of the individual filters are:

STAGE 1 WASHABLE FOAM PREFILTER: 3 to 6 months

STAGE 2 HEPA FILTER: 2 to 5 years

STAGE 3 INNER BLANKET: 6 to 12 months

The useful service life of the filters is directly related to the volume of air passed through the system and the amount of contaminants in the air. If your indoor air contains abnormally high levels of airborne contaminants (such as cigarette smoke) the life of the filters may be shortened.

The HEPA filter's particulate removal efficiency actually improves with use as it loads up with particulates. However, as it loads up it also becomes more difficult to move air through the system. If you notice a significant drop in air flow from the unit, inspect the HEPA filter. If the filter media is darkened on the outer side, the HEPA filter should be replaced.

Specifications (all models)

CLASSIFICATION

- Portable (High Efficiency Particulate Arrestance) 100% Sealed Air Cleaning Device
- N.R.T.L. approved

MATERIALS: 24 gauge cold rolled steel

FINISH: Powder coated baked enamel

COLOR: Black & Sandstone

EASY TO CHANGE FILTERS

Easily removable tops for quick filter changes. Ask about filter options.

OUTFLOW (Upper Section)

Encloses motor/fan.

INTAKE (Lower Section)

Perforated steel enclosure surrounding a three-stage filter assembly

MOTOR/FAN

- Thermally protected Class "B" insulated motor
- Designed for continuous operation.
- Run tested for 50,000 hours
- Service: 120 Volt, 60 Hz for 120 Volt Operation or 230 Volt, 50/60 Hz for 230 Volt Operation

CONTROL: Three speed operation

Model HEPA+™ 2000

DIMENSIONS: 13" D 12.5" H

WEIGHT: 14.5 lbs.

AIR FLOW (C.F.M.): 175

POWER USAGE: 84 Watts

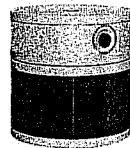

Model HEPA+™ 3000

DIMENSIONS: 13" D 21.5" H

WEIGHT: 27 lbs.

AIR FLOW (C.F.M.): 300

POWER USAGE: 120 Watts



Portable Air Filtration Systems

Instruction Manual Models HEPA+2000 & HEPA+3000

Read and keep
this manual for
reference purposes

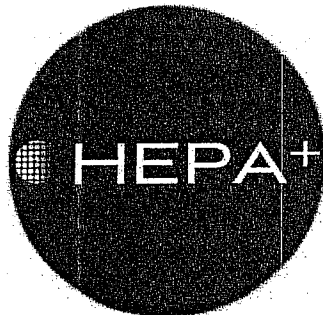
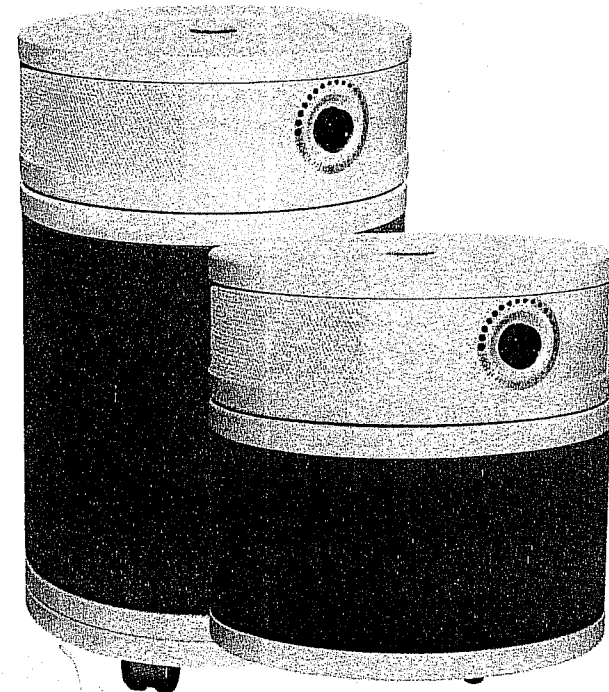

Thank you for purchasing a HEPA+™ portable air filtration system. With proper care and maintenance, your HEPA+™ system will provide many years of reliable service, improving the quality of your air.

INSTALLATION

1. Place the unit in the area where you want the cleanest air.
2. Plug the unit into a live grounded outlet. The cord has either a 110V plug (for 110 volt operation) or a 220V plug (for 220 volt operation) depending on the area in which the unit was sold.
3. Turn the unit on by rotating the control dial clockwise until you hear or feel it click. The unit will start on the "LOW" position. To increase the air flow continue to rotate the control dial clockwise.
4. To turn the unit off, rotate the control dial counter-clockwise until you hear or feel it click into the "OFF" position.

CAUTION

1. Make sure the cord is not in the path of people walking or where anything can be rolled over it.
2. Do not place any objects on top of the unit or allow anyone to sit on it.
3. NEVER place any liquids or plants on the unit. Moisture could leak into the unit and damage the filter media or electrical components.
4. The air filtration system discharges the cleaned air through the vent at the top of the unit. On "HIGH" the velocity of the air coming out is high to enhance circulation throughout the area being cleaned. If the airflow is bothersome or creates a draft, turn the unit until the air is directed toward an unoccupied area of the room.

NOTE: You may notice a slight "new" smell from the unit when your first turn it on. This is normal and harmless and will dissipate within a few days.

THREE-STAGE FILTRATION

STAGE 1: Foam Prefilter

Removes large particulates. Extends the life of the HEPA filter.

STAGE 2: HEPA filter

99.97% efficient @ 0.3 microns. Removes dust, pollen, bacteria, animal dander, attached viruses, cigarette smoke, radon daughters and more.

STAGE 3: V.O.C. filter

Removes odors and hazardous chemicals that may off-gas from cleaners, paints, solvents, carpets, furniture and other items containing synthetic materials.

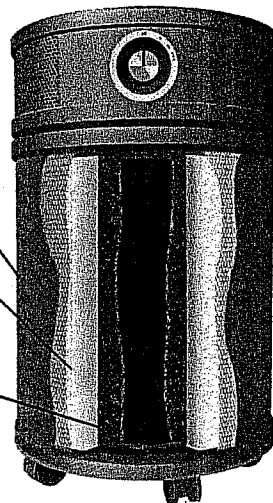

FILTER REPLACEMENT INSTRUCTIONS

Removing the Filter Assembly

1. Turn the switch to the 'off' position and unplug the power cord from outlet.
2. Place the unit upside down on a soft surface
3. *This step requires a friend's assistance* Have someone hold the motor assembly stationary while you twist the filter assembly counter-clockwise to release it, then lift to remove.

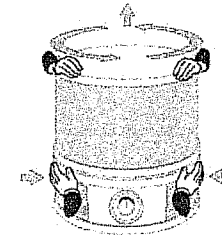

4. Remove the foam 'O'-ring and put it in a place where it will not be damaged or lost. It will be needed during re-assembly.

Replacing the Foam Pre-Filter

1. Place the filter assembly in an upright position on a soft surface
2. Gently pull the foam pre-filter upwards to remove it from the assembly.
3. To replace with a new or washed* pre-filter, carefully spread the foam filter around the outer edges of the filter assembly and gently pull it down to its original position (covering the exposed steel mesh)

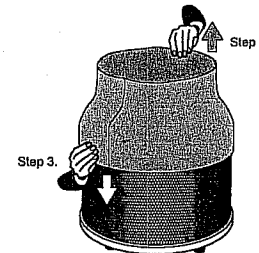

* In order to increase filter life, foam pre-filters may be hand washed, allowed to dry, and re-used. Over time and increased washings the filter will eventually need to be replaced.

Replacing the Inner Blanket

Caution: When completing the following steps, please use extreme care not to inflict pressure on the HEPA Cartridge when replacing the Inner Blanket

1. Look inside the Filter Assembly to locate an end of the Inner Blanket.
2. Without applying pressure directly on the HEPA filter located behind the Inner Blanket, fold the ends of the old Inner Blanket in and remove it from the unit.
3. Insert the new Inner Blanket inside the HEPA Cartridge with the edges overlapped by at least one inch. Once it is in position gently spread the Inner Blanket against the HEPA filter until the two ends of the blanket meet.

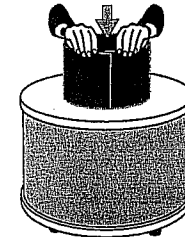

Hepa Cartridge Replacement

1. Remove and carefully discard the old HEPA Cartridge. (Filter Assembly)
2. Install the new HEPA Cartridge. (Filter Assembly) see: 'Re-Assembling the Unit'

Re-Assembling the Unit

1. Gently place the motor assembly upside down on a soft surface
2. Place the foam 'O'-ring onto the Motor Assembly (if a new foam 'O'-ring is available, use it in place of the old one)
3. *This step requires a friend's assistance* Have a friend support the Motor Assembly, place the Filter Assembly on top of the Motor Assembly and firmly twist the Filter Assembly clockwise until both assemblies are locked together.
4. Place the unit in its upright position. Your unit is now ready for use.